

# Permavoid 85mm Podium Deck Roof Gully Access Chamber

Data Sheet

## PRODUCT INFORMATION

P1

ISSUE 2 - JULY 2018

Product code: PVOD01201

The Permavoid 85mm Podium Deck Roof Gully Grate Access Chamber has been specifically designed for use in shallow Permavoid podium deck construction. The chamber is set within 85mm deep Permavoid allowing easy connection to the surrounding Permavoid using propriety Permaties. Rainwater is collected via the grating, filtered through the perforated walls and dispersed into the surrounding Permavoid storage system. The gully has an integral silt basket and is easily accessible for clearing of silt and debris during routine maintenance. Gully grating and frame not included.



### Key Benefits

- Effective water dispersal
- Integrates with surrounding Permavoid
- Easy access for maintenance
- Integrated silt basket
- Passive flow management
- 100% recyclable

### Application 1 - maximum cover approximately 500mm

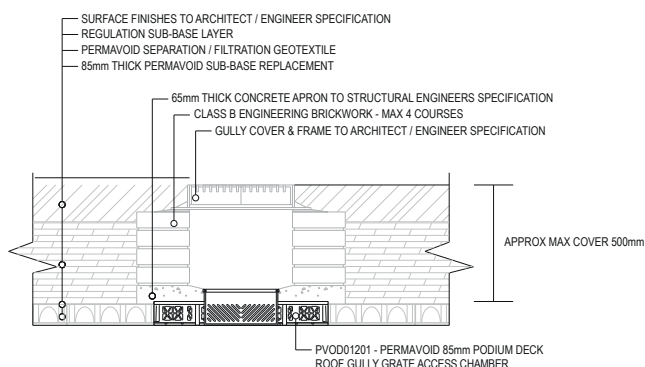

### Application 2 - minimum cover approximately 180mm

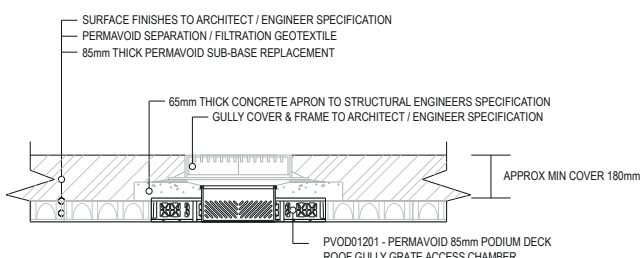

ELEMENT	VALUE
<b>PHYSICAL PROPERTIES</b>	
Length	710mm
Width	710mm
Depth	147mm
Sump depth	10mm
Unit weight	11kg
Material	HDPE/PP
<b>PACKAGING DETAILS</b>	
Packaging unit type	Double wall cardboard
Packaging unit dimension	732(L) x 732(W) x 169(H) mm
Packaging unit weight	11kg
Number of units per pallet	18
Pallet dimensions	1200(L) x 1200(W) x 1620(H) mm
Pallet weight	223kg

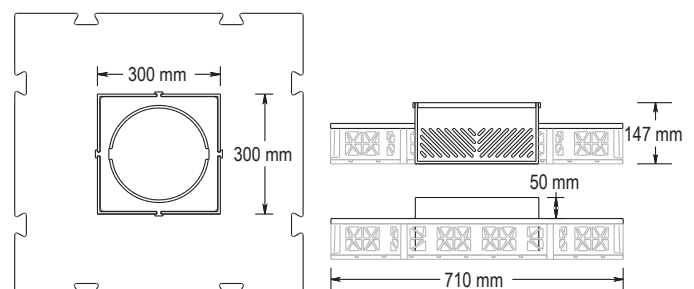

### Technical Support

Detailed guidance and assistance is available.

For further information, please contact our Technical Team on

+44 (0)1509 615 100 or email: [civils@polypipe.com](mailto:civils@polypipe.com)

on +44 (0)1509 615 100 or email: [civils@polypipe.com](mailto:civils@polypipe.com)

or visit [www.polypipe.com/civils-technical-hub](http://www.polypipe.com/civils-technical-hub)

Polypipe Civils,

Charnwood Business Park, Loughborough, Leicestershire LE11 1LE

Tel: +44 (0)1509 615100 Fax: +44(0)1509 610215 Email: [civils@polypipe.com](mailto:civils@polypipe.com)

[www.polypipe.com/wms](http://www.polypipe.com/wms)



# Permavoid 85mm Podium Deck Roof Gully Access Chamber

Data Sheet

PRODUCT INFORMATION

P2

ISSUE 2 - JULY 2018

Permavoid 85mm Podium Deck Roof Gully Access Chamber can be utilised in these SuDS techniques

TECHNIQUES													
Blue-Green roofs	Podium Decks	Trees	Sports Pitches	Cycle Paths	Permeable Paving (sub base & podium)	Bioretention & Rain Gardens	Attenuation Storage Tanks	Infiltration	Swales	Filter Drains	Detention Basins	Ponds & Wetlands	Filter Strips
✓	✓												

Visit [www.polypipe.com/greeninfrastructure](http://www.polypipe.com/greeninfrastructure)

All descriptions and illustrations in this publication are intended for guidance only and shall not constitute a 'sale by description'. All dimensions and weights given are nominal and Polypipe may modify and change the information, products and specifications from time to time for a variety of reasons, without prior notice. The information in this publication is provided 'as is' on July 2018. Updates will not be issued automatically. This information is not intended to have any legal effect, whether by way of advice, representation or warranty (express or implied). We accept no liability whatsoever (to the extent permitted by law) if you place any reliance on this publication you must do so at your own risk. All rights reserved. Copyright in this publication belongs to Polypipe and all such copyright may not be used, sold, copied or reproduced in whole or part in any manner in any media to any person without prior consent. © Polypipe is a registered trademark of Polypipe. All Polypipe products are protected by Design Right under CDPA 1988. Copyright © 2018 Polypipe. All rights reserved.